

Sign Install and Display Set-Up

Step 1

Remove Base (1) from packaging. Flip over to back side and remove drain cap. Fill base to your desired weight with selected medium and put cap back on.

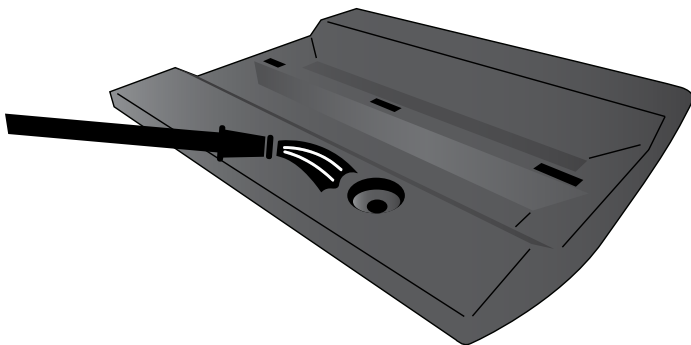

*Base holds 2.3 gallons of water, weighing 24.5lbs when full

Step 2

Place Base (1) in desired location and insert Graphic (2) into the middle slot of the base until it presses up against the bottom.



Storage

Store in a cool dry location.

Care

To clean, wipe with damp cloth.

Warranty Information: All products are designed to provide the user with a cost-effective and durable product. Standard warranty is a 'one year parts and labor' warranty which warrants product against defects in material and workmanship. It does not cover damage due to accidents, abuse, or normal wear and tear. Products found to be defective will be replaced or repaired at factory's discretion.